

# TEA COMMERCIAL LAND

715 FIGZEL COURT TEA SD 57064

**FOR  
SALE**



Just Minutes from Sioux Falls



## SIZE

33,124 SF



## PRICE

\$4.50 PSF CASH



## LOCATION

Just off Heritage Pkwy on Figzel Ct, near many thriving businesses. Tea is just 5.9 miles from W 41<sup>st</sup> St in Sioux Falls to Heritage Pkwy.



## ZONED

General Business



## POPULATION

2020 estimated at 6,444. Tea is one of the fastest growing cities in SD.



## NEIGHBORS

Fitness First of Tea, Postal Service, Avera Medical Group Tea, Pizza Ranch, Ace Hardware, Fareway Grocery & many more.

Information deemed reliable but not guaranteed.



**STEVE  
VAN BUSKIRK**  
**605.366.0939**  
[steve@vbclink.com](mailto:steve@vbclink.com)

605.361.8211 | [VBCcommercial.com](http://VBCcommercial.com)

2571 S Westlake Dr #100 Sioux Falls SD 57106

# AREA MAP



605.361.8211 | [VBCcommercial.com](http://VBCcommercial.com)

2571 S Westlake Dr #100 Sioux Falls SD 57106

**STEVE**  
**VAN BUSKIRK**  
**605.366.0939**  
[steve@vbclink.com](mailto:steve@vbclink.com)



PARCEL IMAGE

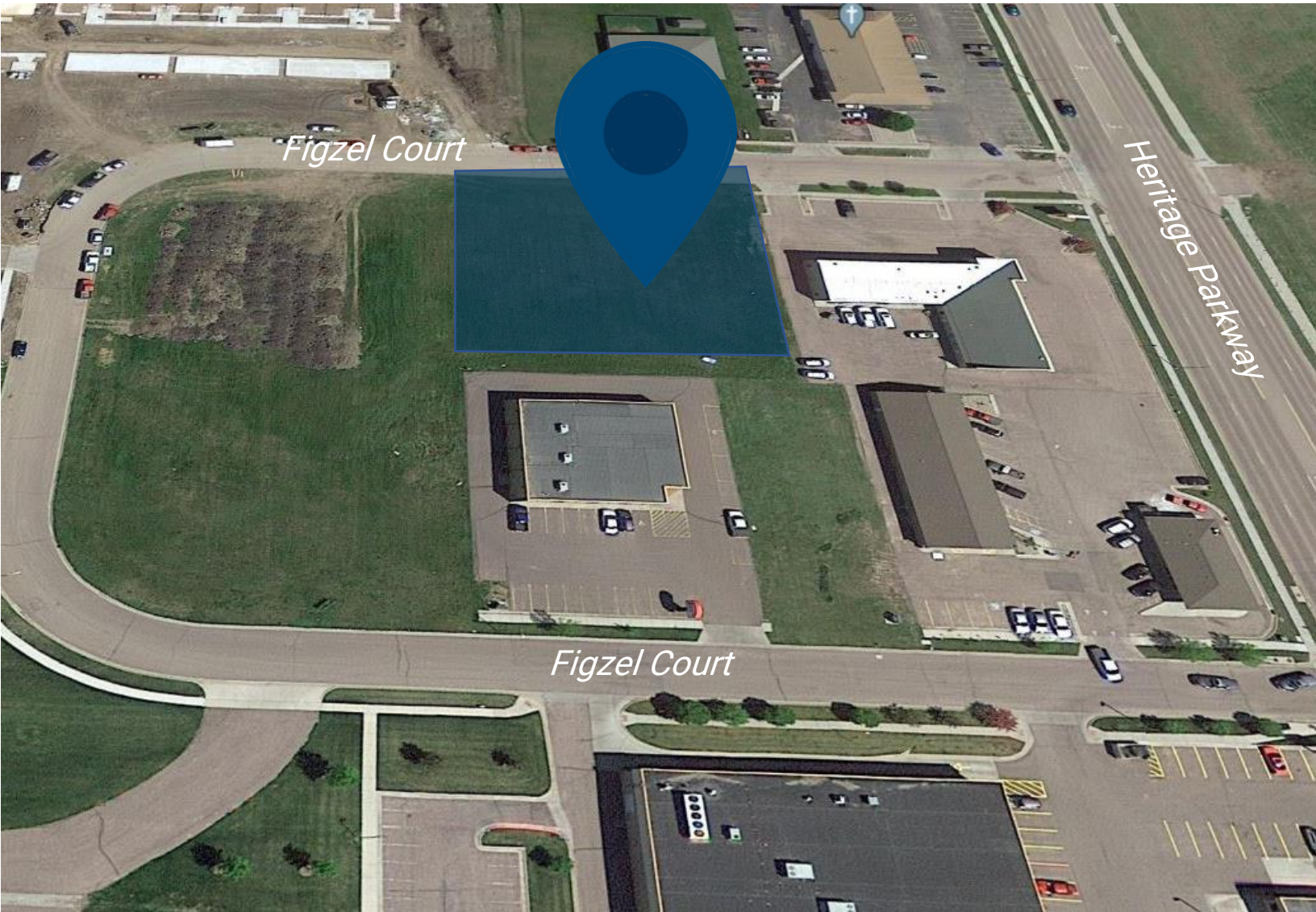

**STEVE**  
**VAN BUSKIRK**  
**605.366.0939**  
[steve@vbclink.com](mailto:steve@vbclink.com)

605.361.8211 | [VBCcommercial.com](http://VBCcommercial.com)

2571 S Westlake Dr #100 Sioux Falls SD 57106

# LOCATION MAP

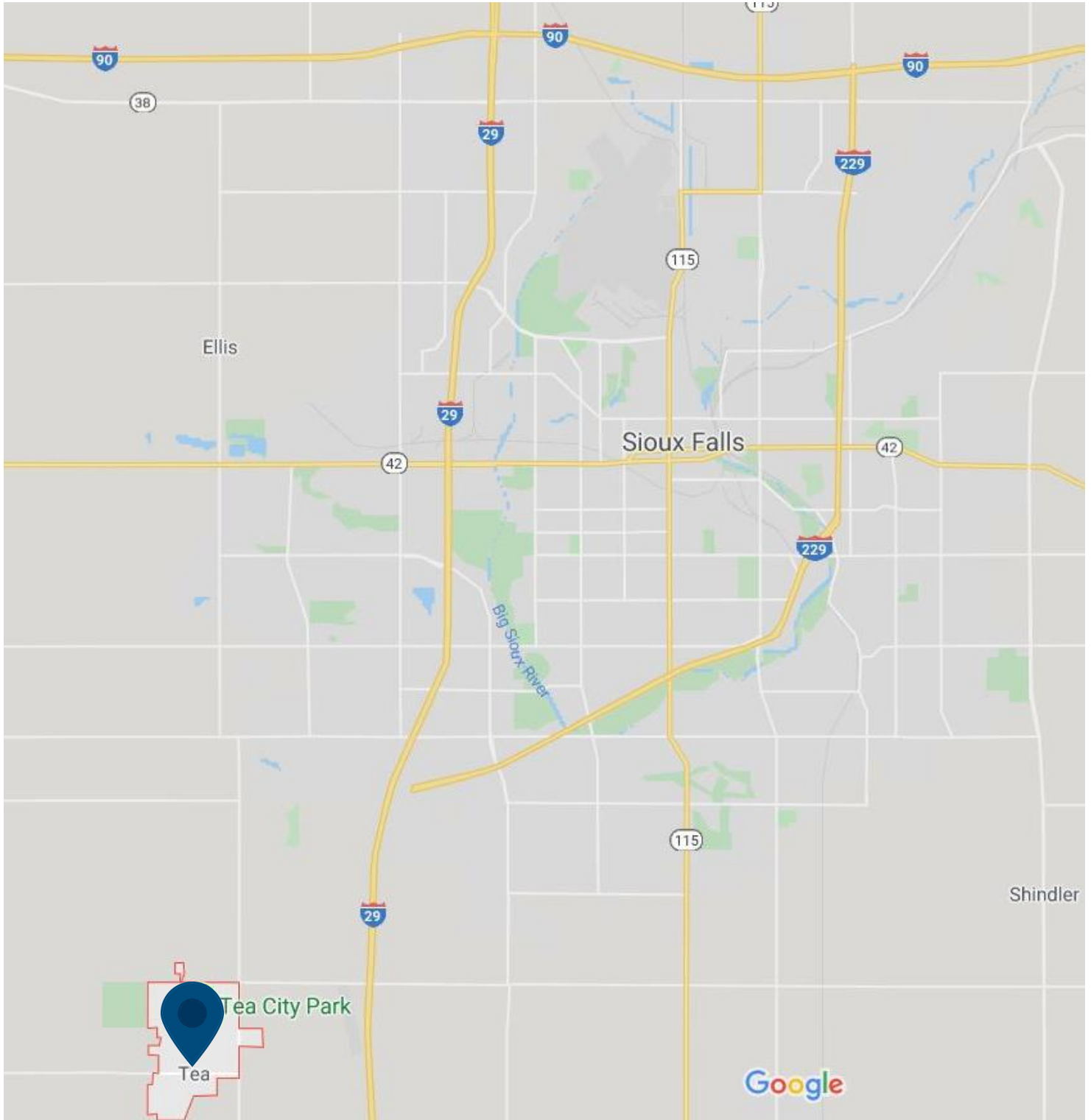

**STEVE**  
**VAN BUSKIRK**  
**605.366.0939**  
[steve@vbclink.com](mailto:steve@vbclink.com)

605.361.8211 | [VBCcommercial.com](http://VBCcommercial.com)

2571 S Westlake Dr #100 Sioux Falls SD 57106