

**FOR
LEASE**

HEATHER RIDGE OFFICE PARK

6340 South Western Avenue, Sioux Falls, SD 57108
SUITE 120



Move in Ready Executive Office Suite



SIZE
528 SF



PRICE
\$ 1,300.00 GROSS
+Utilities



LOCATION

Just south of 69th St. on S. Western Avenue. This office park has ample parking and is visible to traffic with convenient access to nearby restaurants and retail.

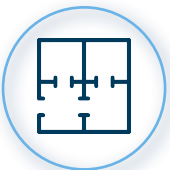

LAYOUT

This suite offers a reception area, two private offices with large windows, kitchenette and shared restrooms.



AVAILABLE
Move-In-Ready



CO-TENANCY

First Dakota Title, Bangs & McCullen Law Firm, Wells Fargo Advisors, Starbucks, McNally's Irish Pub, Faini Design Jewelry Studio, Daily Clean Food, 22 Ten Kitchen & Cocktails, The Bridges at 57th Street.

Information deemed reliable but not guaranteed.



(605)-361-8211 | vbclink.com
2571 S Westlake Dr #100 Sioux Falls SD 57106



(605)-351-5512
autumn.kaufhold@vbclink.com

AREA MAP



(605)-361-8211 | vbclink.com
2571 S Westlake Dr #100 Sioux Falls SD 57106



(605)-351-5512
autumn.kaufhold@vbclink.com

SITEPLAN

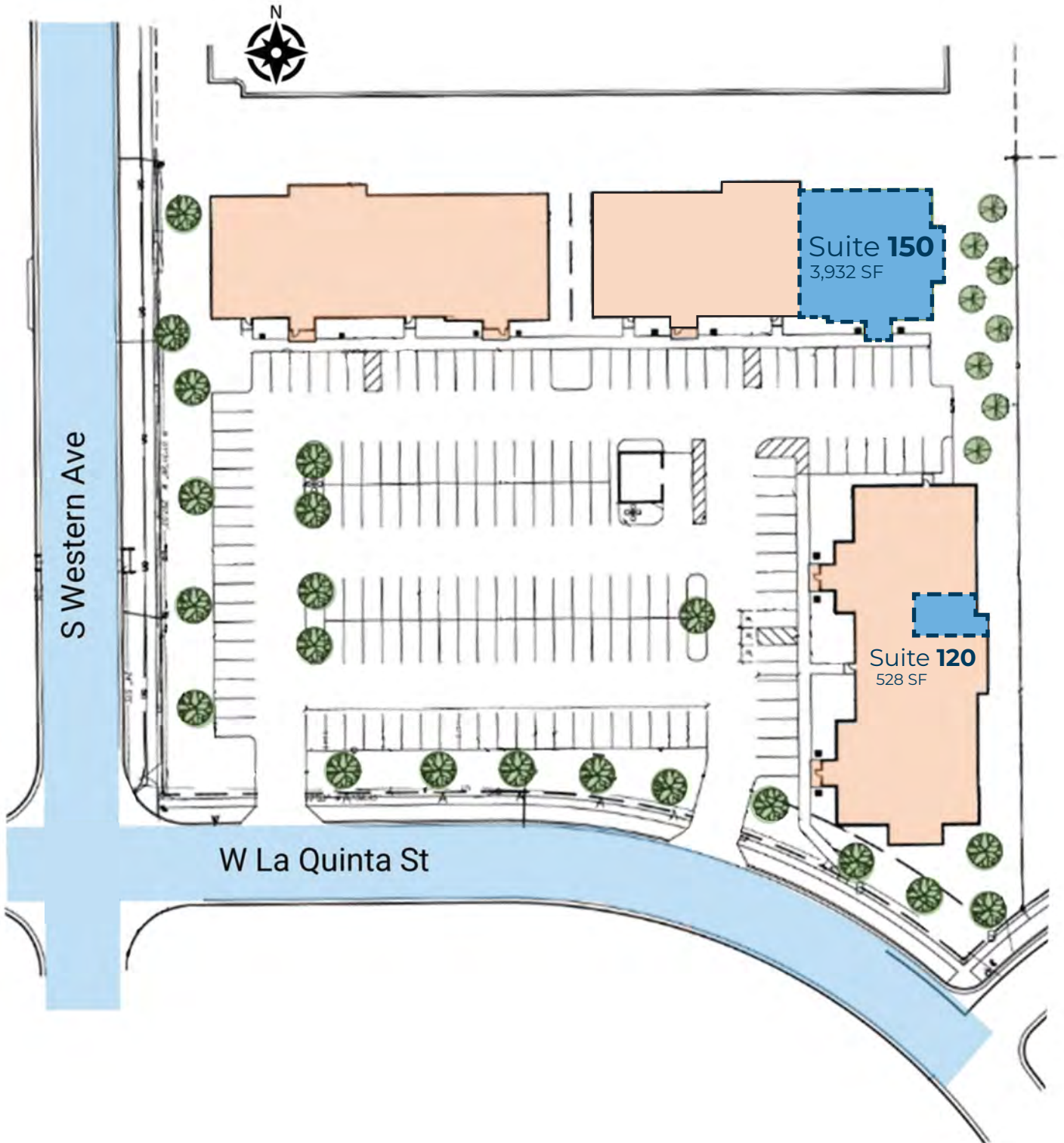

(605)-361-8211 | vbclink.com
2571 S Westlake Dr #100 Sioux Falls SD 57106



(605)-351-5512
autumn.kaufhold@vbclink.com

FLOORPLAN

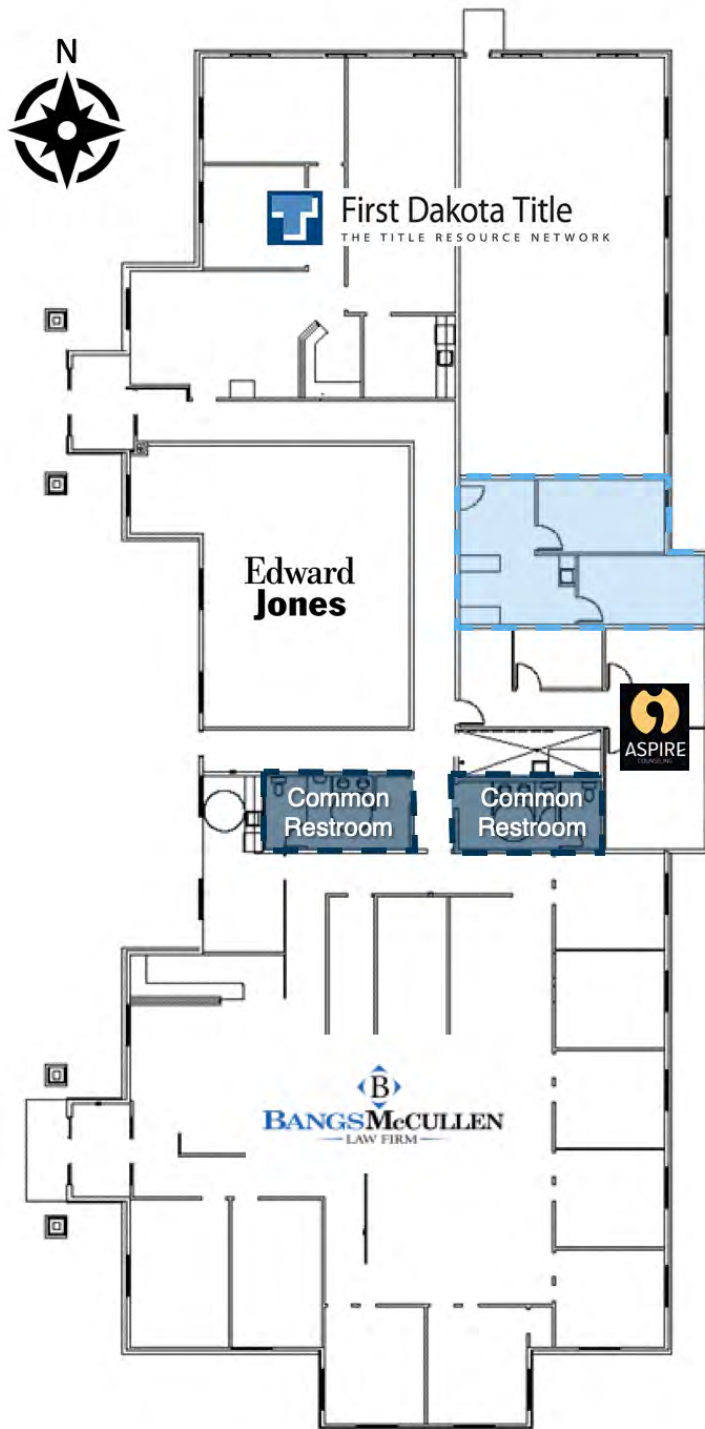

Suite **120**

528 SF



(605)-361-8211 | vbclink.com
2571 S Westlake Dr #100 Sioux Falls SD 57106



(605)-351-5512
autumn.kaufhold@vbclink.com

PHOTO GALLERY



(605)-361-8211 | vbclink.com
2571 S Westlake Dr #100 Sioux Falls SD 57106



(605)-351-5512
autumn.kaufhold@vbclink.com