



KARLSON INDUSTRIAL II

Tea, South Dakota

2,400-sqft Bay For Lease



27084 Kerslake Place
Tea, SD 57064



size

2,400 sqft



price

\$1,900/month
(gross + utilities)



details

- Built in 2022
- 1 office with A/C and window
- 16' sidewalls
- 14'x14' overhead door
- 1 rear door
- 2 walk-in doors
- Concrete apron, asphalt lot



location

Property is located in Kerslake 2nd Addition in Tea, South Dakota, with close proximity to Interstate 29. Site located just south of Sioux Falls, SD



layout

Space is 40' wide by 60' deep, with one office, mezzanine, restroom and mechanical room.

Information deemed reliable but not guaranteed.



Lake Lorraine | 2571 Westlake Drive #100
Sioux Falls, South Dakota 57106
VBCLink.com | 605.361.8211



605.376.0127
Ryan@VBCLink.com

FLOOR PLAN

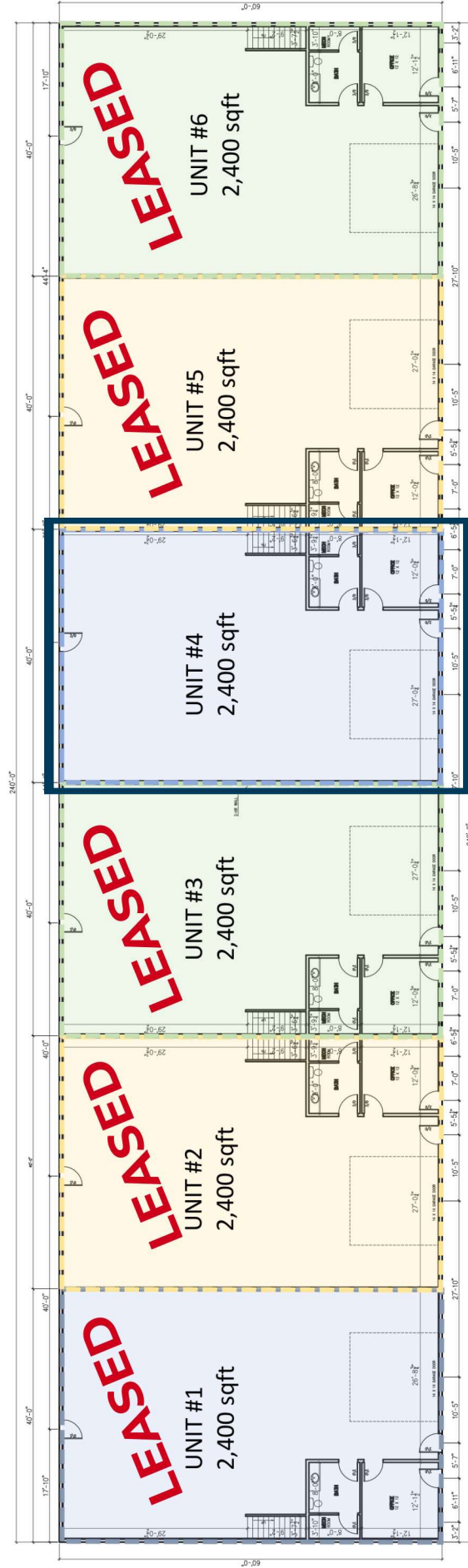

FLOOR PLAN
1/8"=1'-0"
14,400 SF

PROPERTY PHOTOS

