

WM

WESTTOWN MARKETPLACE

41ST STREET & ELLIS ROAD

Retail/Office Space for Lease



8004 West 41st Street
Sioux Falls, SD 57106



size

1,550 sqft



price

\$21.00 per sqft (NNN)

NNN estimate: \$5.50



zoning

Live-Work
(office, services, small retail)



population

50,000 people live in
Sioux Falls WEST of
Interstate 29!



location

New development
located on the NE
corner of 41st Street
and South Purdue
Avenue in West Sioux
Falls.



co-tenancy

Fareway Meat + Grocery,
Starbucks, Dollar Tree,
Sanford Clinic, Family
Wellness, ACE Hardware,
Walgreens, Frontier
Elementary School, Memorial
Middle School, Roosevelt
High School

Information deemed reliable but not guaranteed.



Lake Lorraine | 2571 Westlake Drive #100
Sioux Falls, South Dakota 57106
VBClick.com | 605.361.8211



605.376.0127
Ryan@VBClick.com

LOT 2
6,630 SF±

165 KINDERBROOK AVE.

WEST LOBELIA STREET

W. SNAPPDRAGON

8. PURDUE AVENUE

LOT 15
BLOCK 4



SOLD

SOLD

Valentino's
CLASSIC ITALIAN PASTORIO

SOLD

FAREWAY
MEAT & GROCERY

SOLD

DOLLAR TREE

SOLD

UNDER CONTRACT

McDonald's

SOLD

Starbucks

SOLD

SILVERSTAR
CAR WASH

SOLD

RETAIL
9,180 SF
1.75 AC.

SOLD

RETAIL/MEDICAL
10,500 SF
2.25 AC.

SOLD

C-STORE
6,600 SF
1.5 AC.

SOLD

ELLIS ROAD

41ST STREET



SITEPLAN

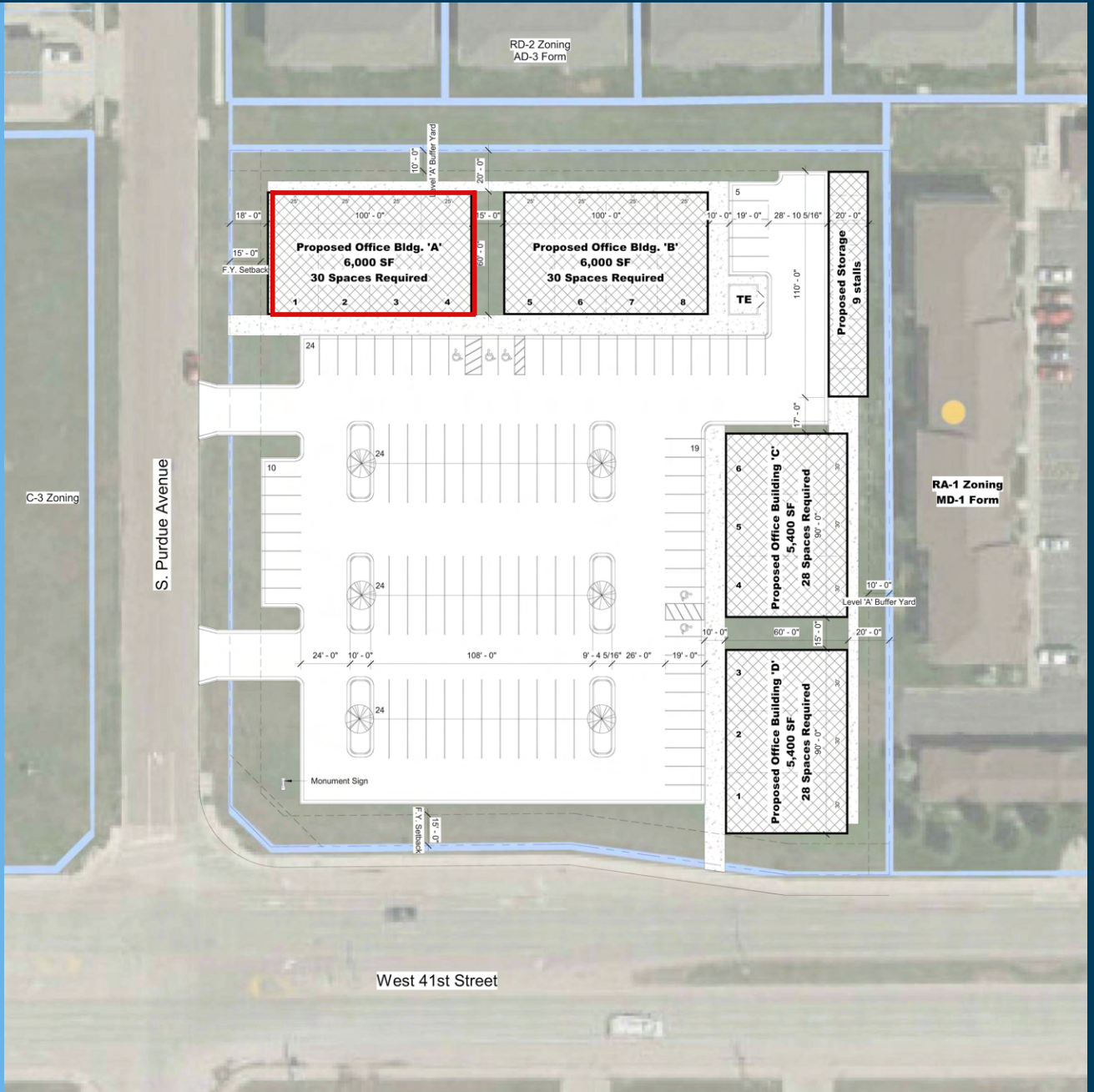

AERIAL RENDERING

1 Site Plan

Scale: 1" = 30'-0"



FLOORPLAN

